

**CODE DATA INFORMATION**

1. PROJECT TITLE: APCHA BSL-3 Laboratory Improvements
2. TYPE OF WORK (circle all that apply)  
 A. New Structure Yes (X) No ( )  
 B. Addition Yes (X) No ( )  
 C. Alteration Yes (X) No ( )  
 D. Change of Use  
 Change of Use: Yes (X) No ( )  
 Partial Yes (X) No ( )
3. EXISTING STRUCTURE ANALYSIS:  
 A. Occupancy Description: Laboratory Use Group: B  
 B. Type of Construction: V-B  
 C. Occupant Load - Existing: 15 No. of Exits: 2  
 Total Area: 1,435 Sq. Ft.  
 D. Allowable maximum floor area excess (increase) for total sprinklers? Yes (X) No ( )  
 Does the above include increases for total sprinklers? Yes (X) No ( )  
 E. Number of stories above grade: Is there a basement? Yes (X) No ( )  
 Total stories including basements: 1 Height: 16  
 F. Fire Protection Systems  
 Emergency System: Yes (X) No ( )  
 Standpipe System: Yes (X) No ( )  
 Smoke Control/Removal System: Yes (X) No ( )  
 G. Fire Alarm System: Yes (X) No ( )  
 H. Accessible to the Disabled: Yes (X) No ( )  
 1. No. of stairs: 1 (100% area - existing building)
- Formed/Developed by the Ohio Design Professionals and Code Officials, Inc.  
 2309 7th Avenue South  
 Birmingham, AL 35233  
 www.karlberger.com  
 205/252-9191  
 (FAX) 205/251-9618

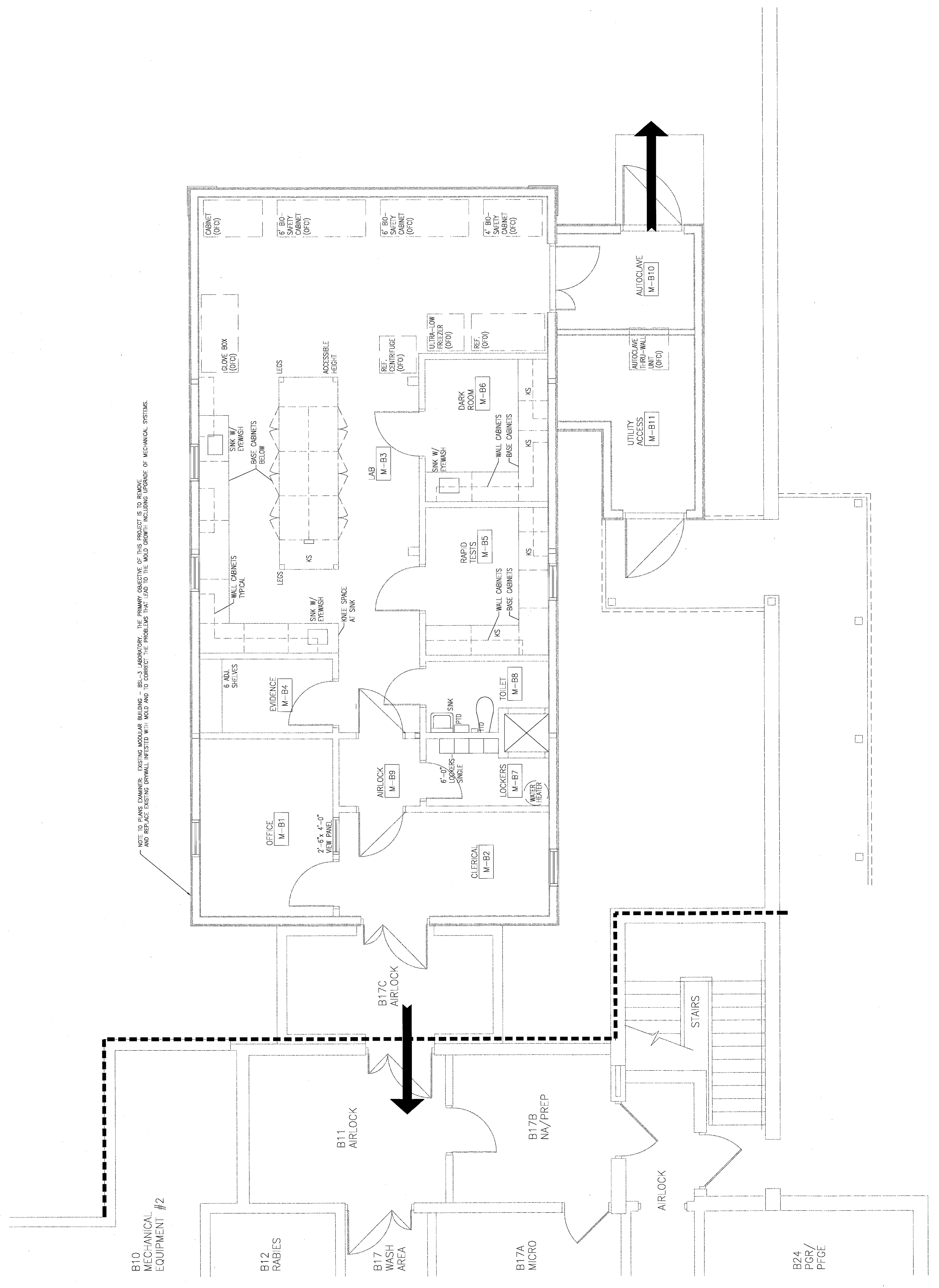

1 LIFE SAFETY PLAN 1/4" = 1'-0"

